



Tuya App Manual

—Without fingerprint—

- 1 Scan QR code to download Tuya APP or Search Tuya on App store to download it.



Scan QR code

or



Search TuyaSmart to download APP



Open Tuya APP to add new equipment

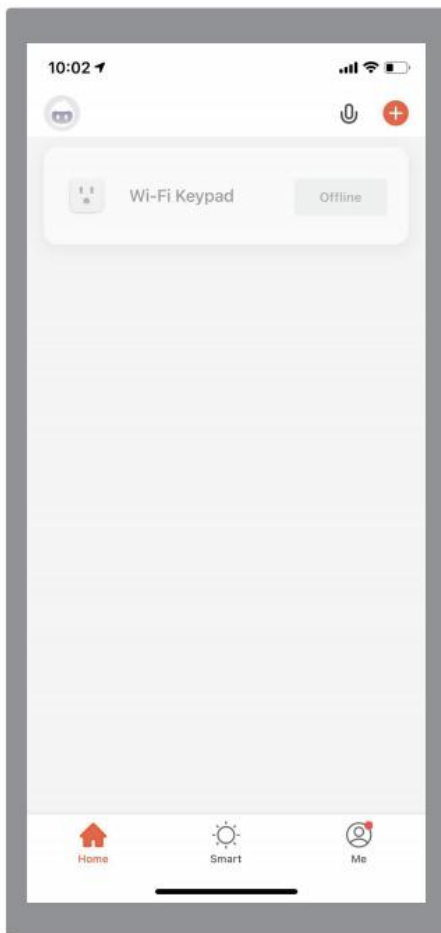

Select "Auto scan", click "Searching"

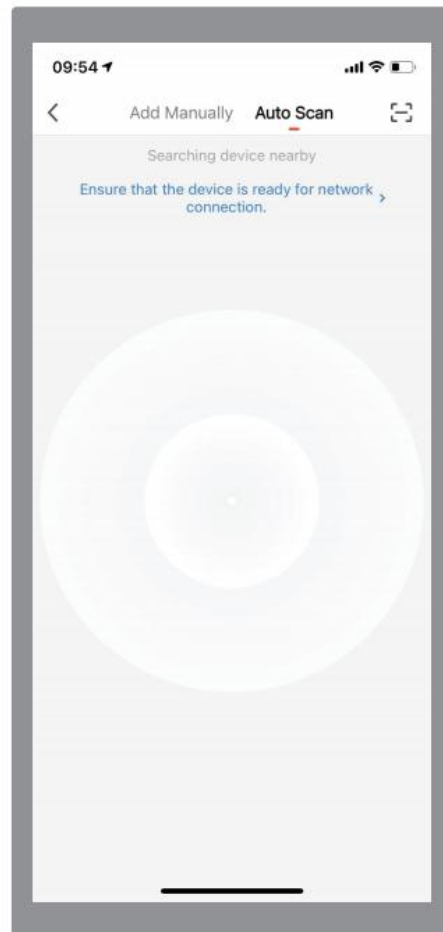

4

Connect with available devices, click “Next”.

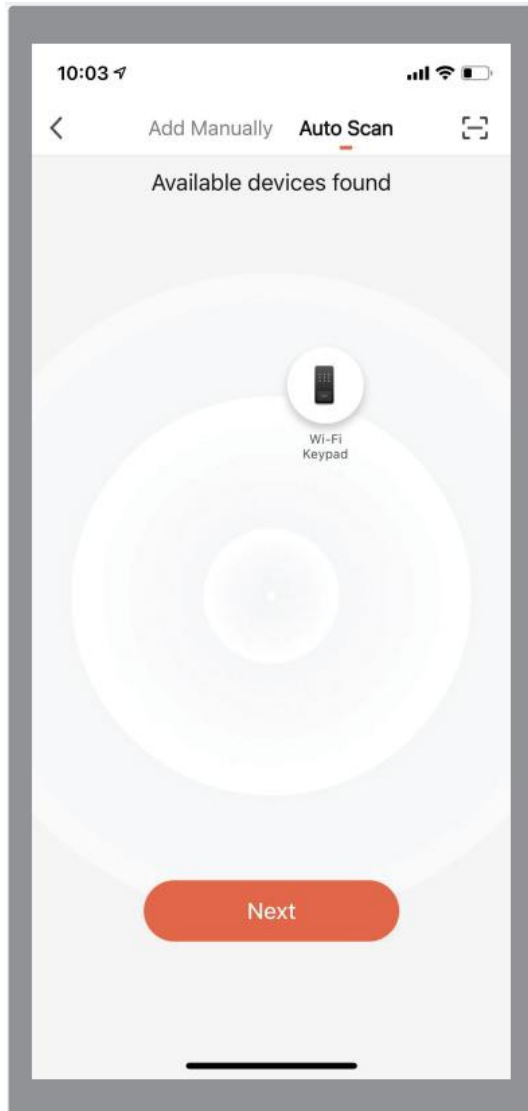

5

Choose Wi-Fi and enter password, click “Next”.

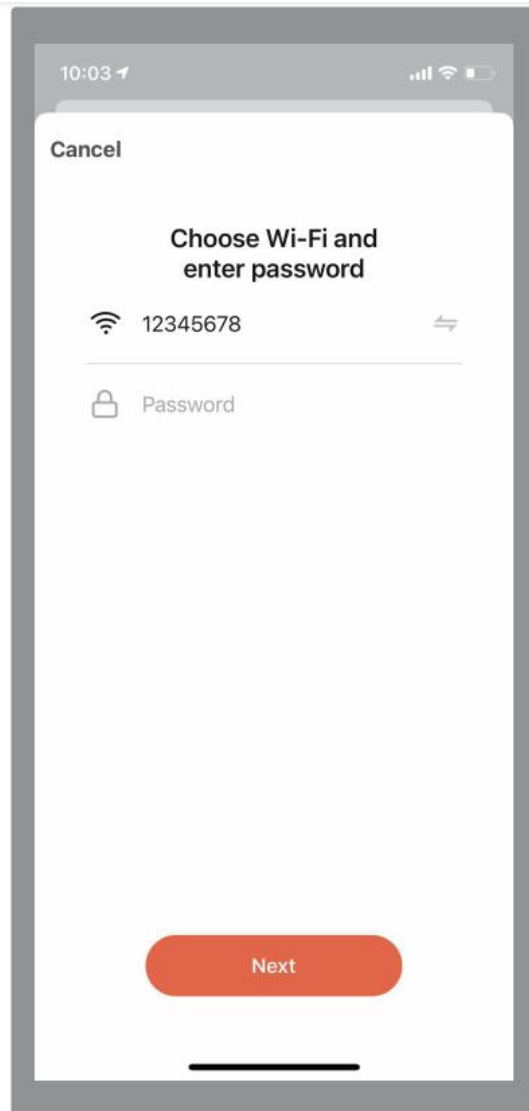

6 Connecting, Added successfully, ,click “Done”.

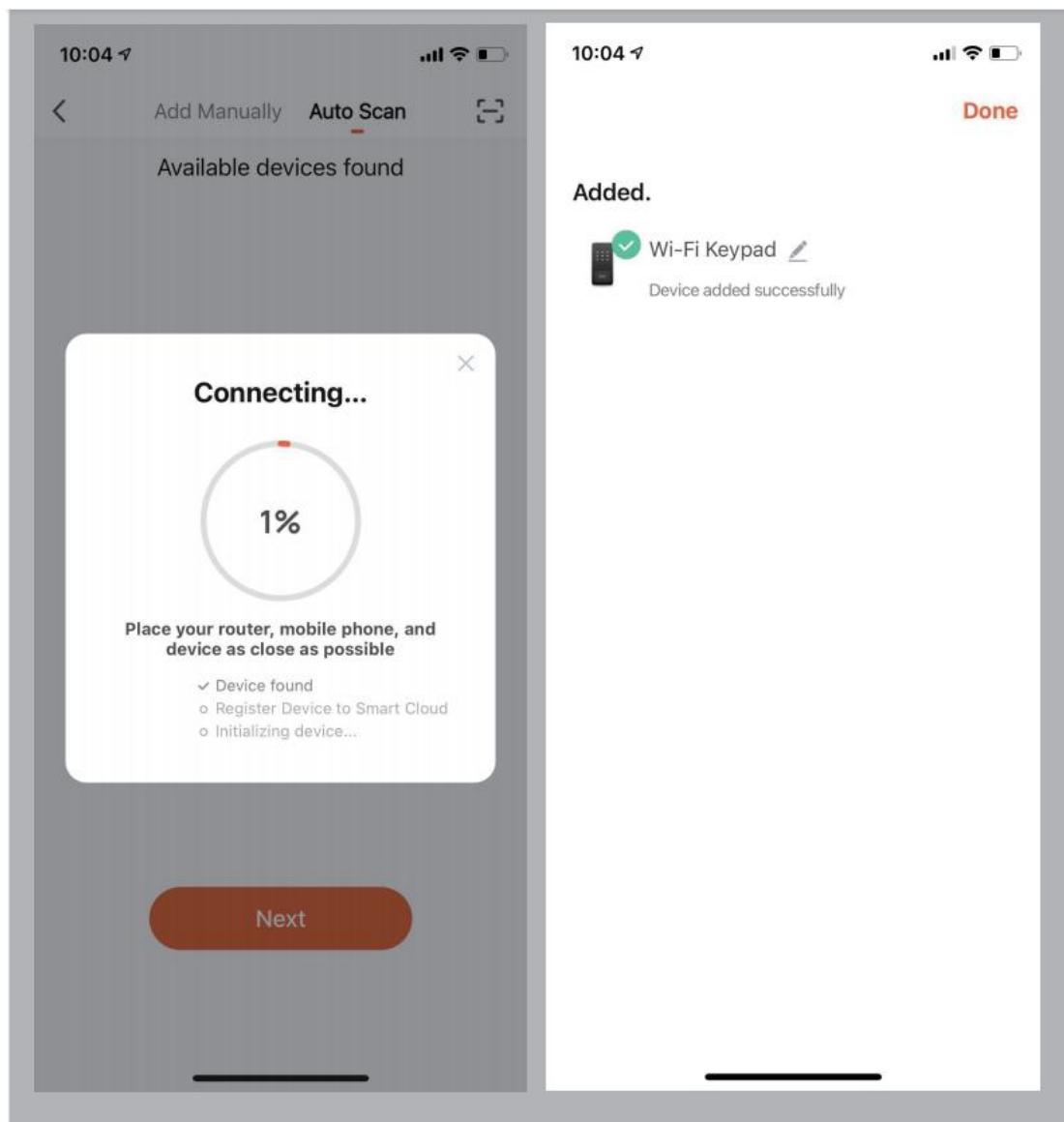

7 Click setting, open remote unlock setting

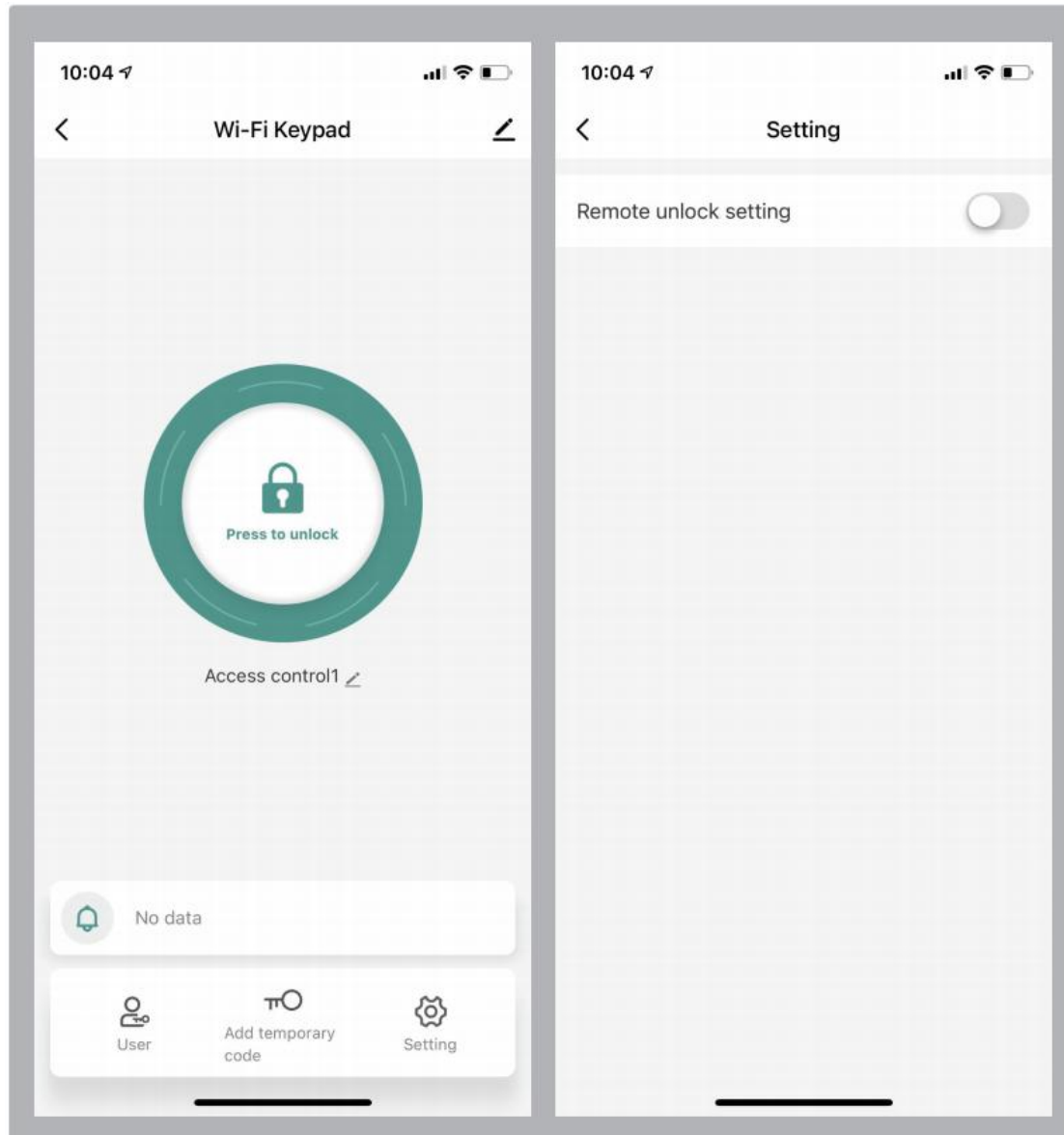

8 Press to unlock

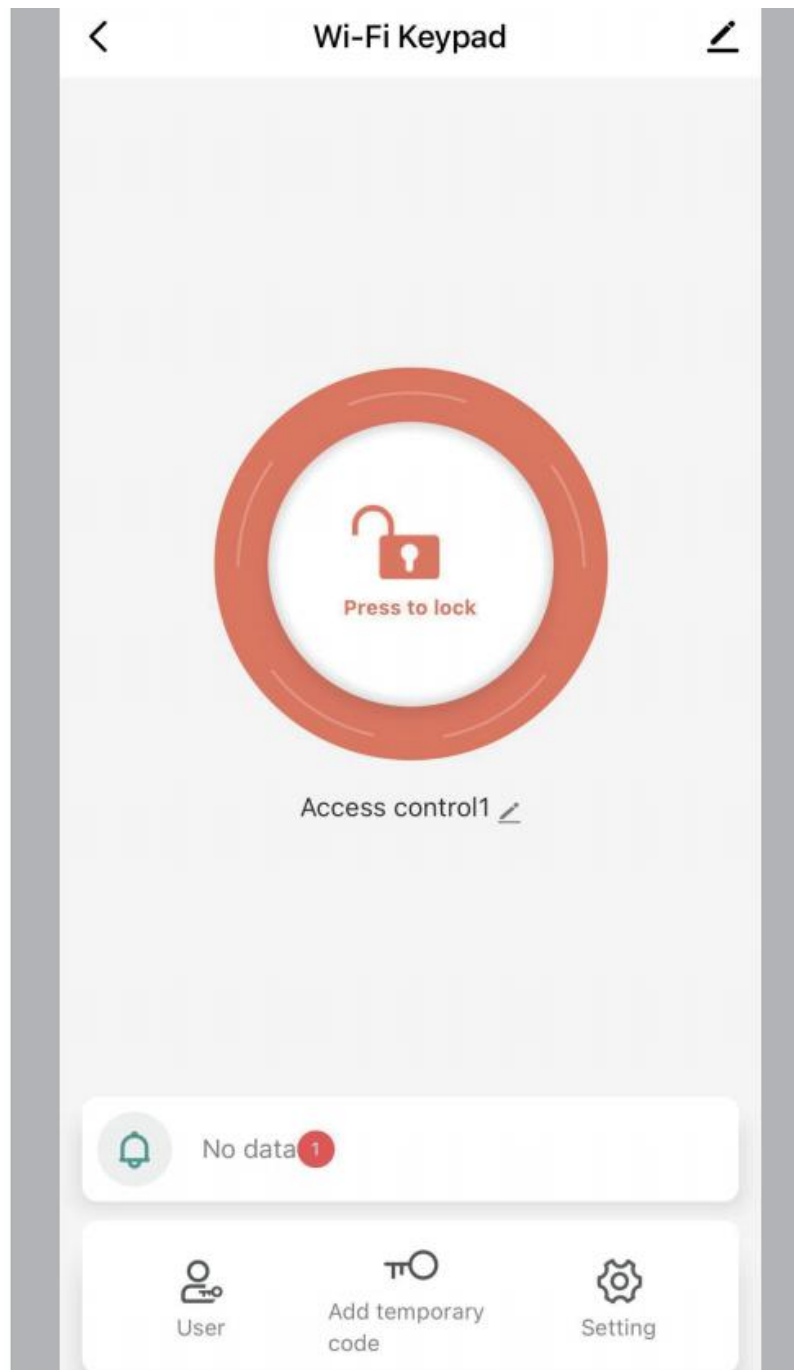

- 9 Select user, click ” + ” to add user, fill in name, click next step, then click “Add” to input 6 digits code or generated code randomly , fill in code name or card name, click “Save “.

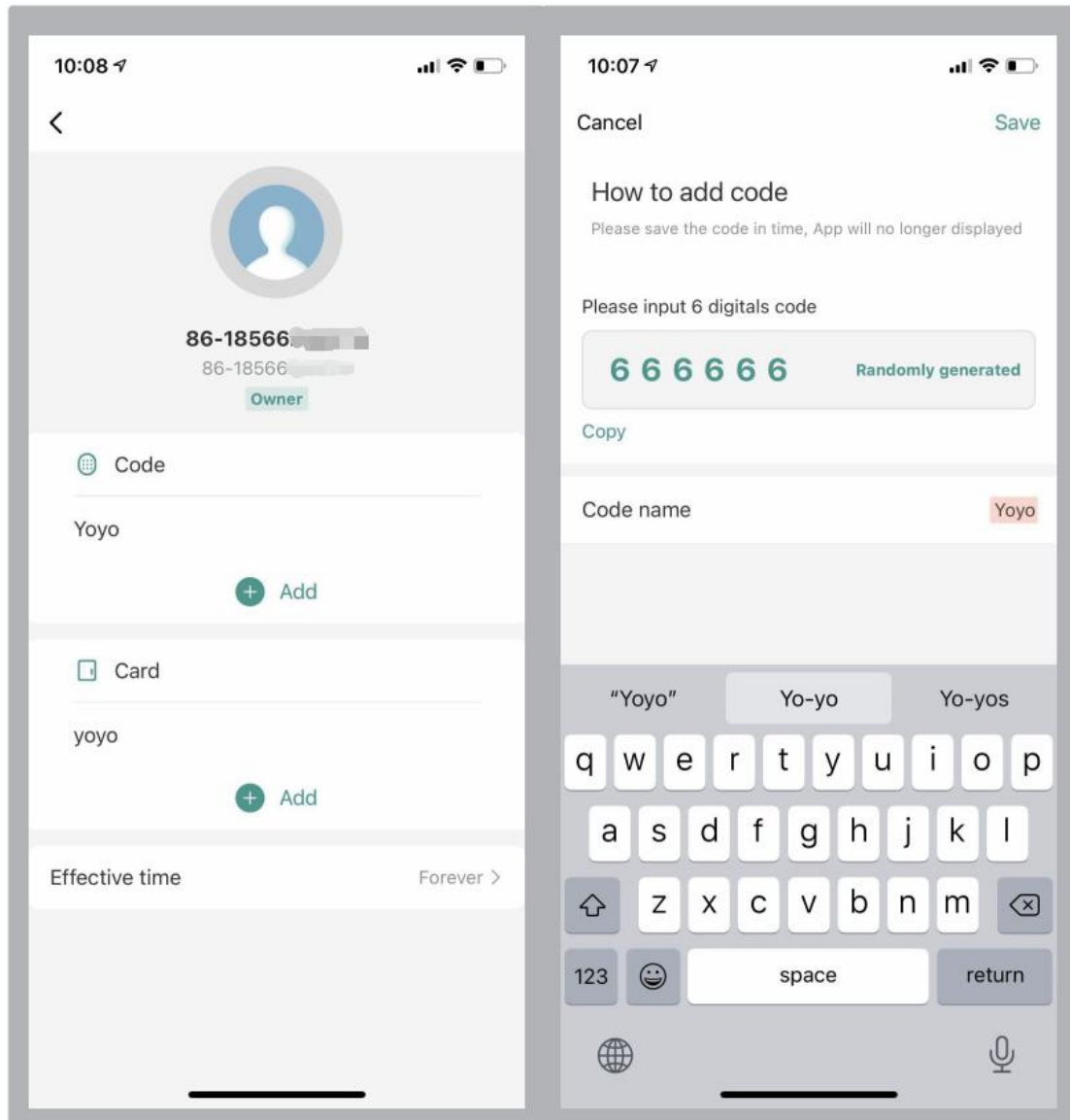

10 Add card by clicking start add

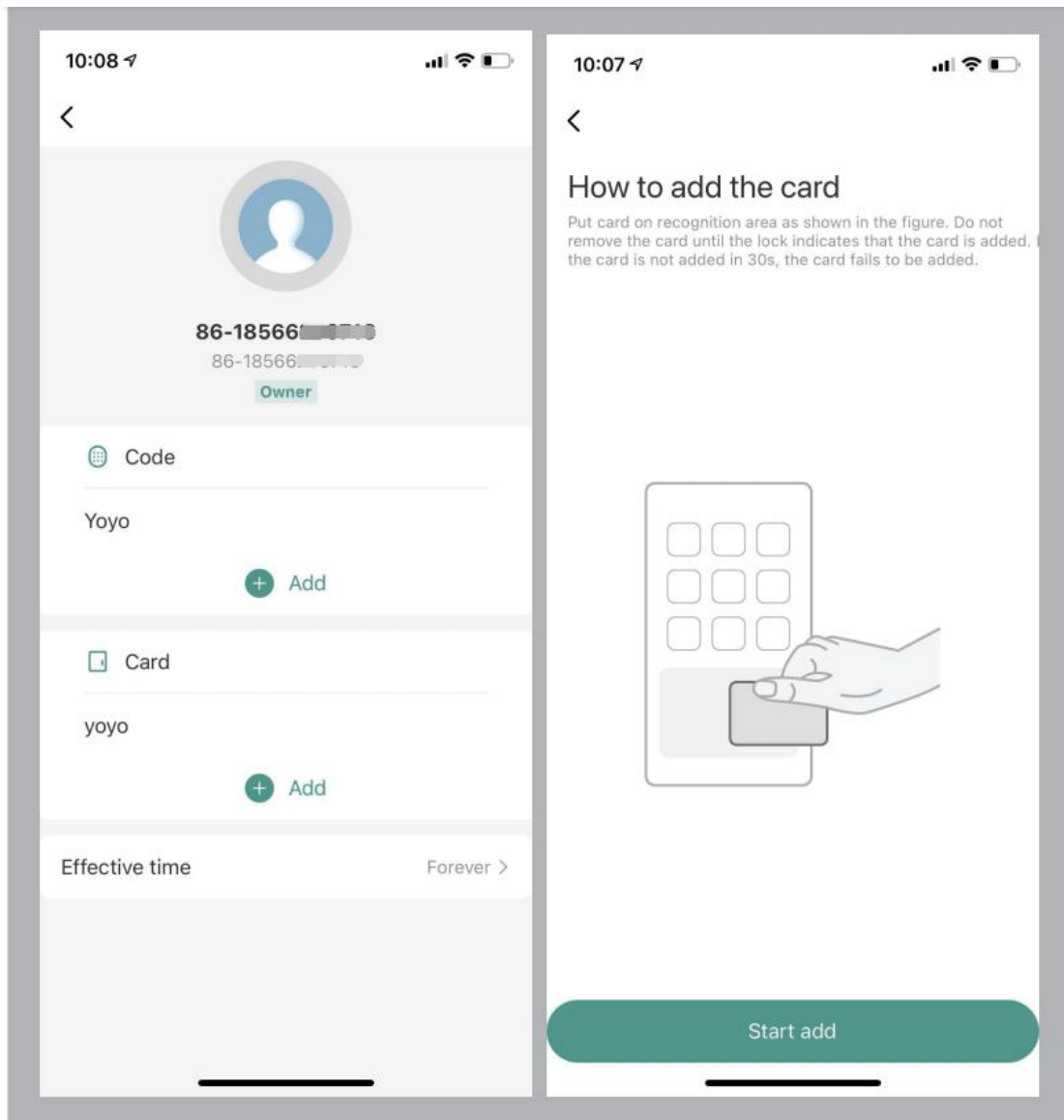

- 11 swiping one card within 60 seconds, add card successfully, then fill card name and click “Done” .

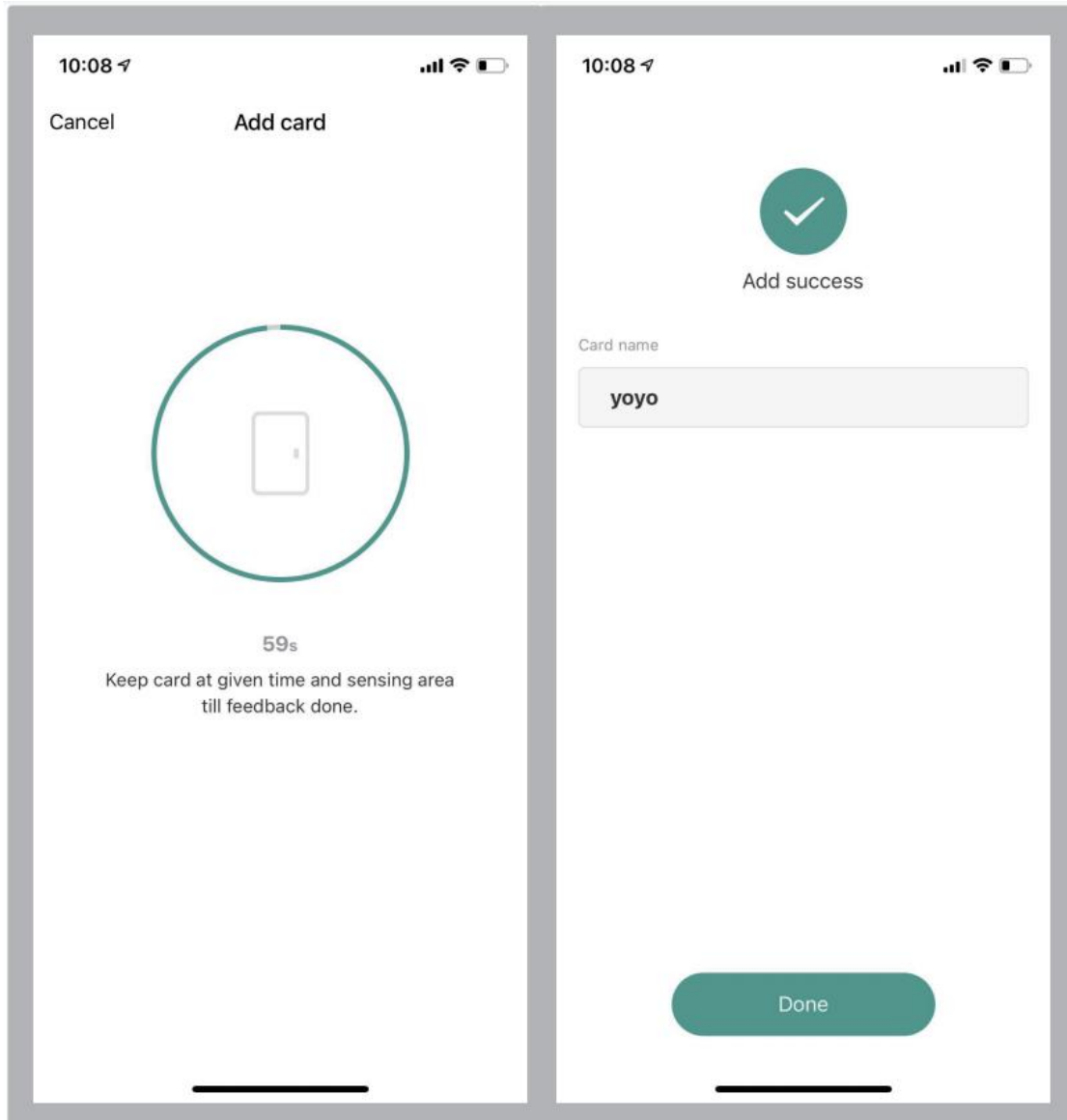

12 Add ordinary user by clicking ordinary member “+”

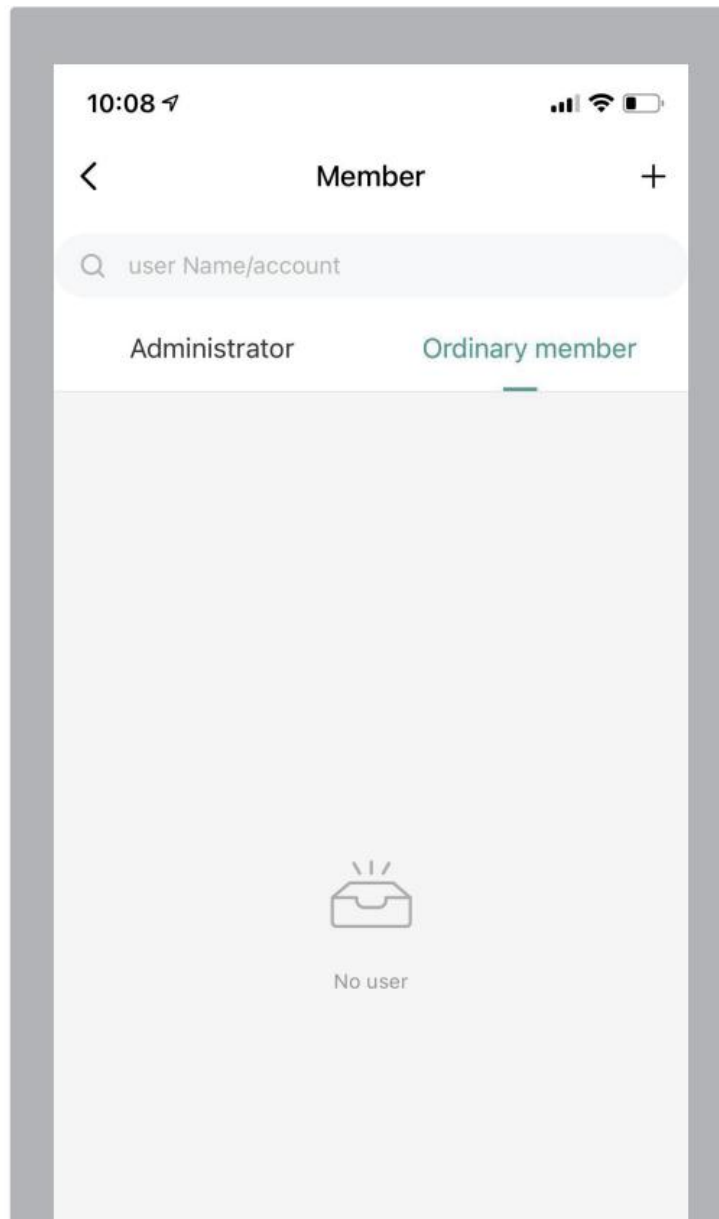

13 then input the related information and click “Next step”.

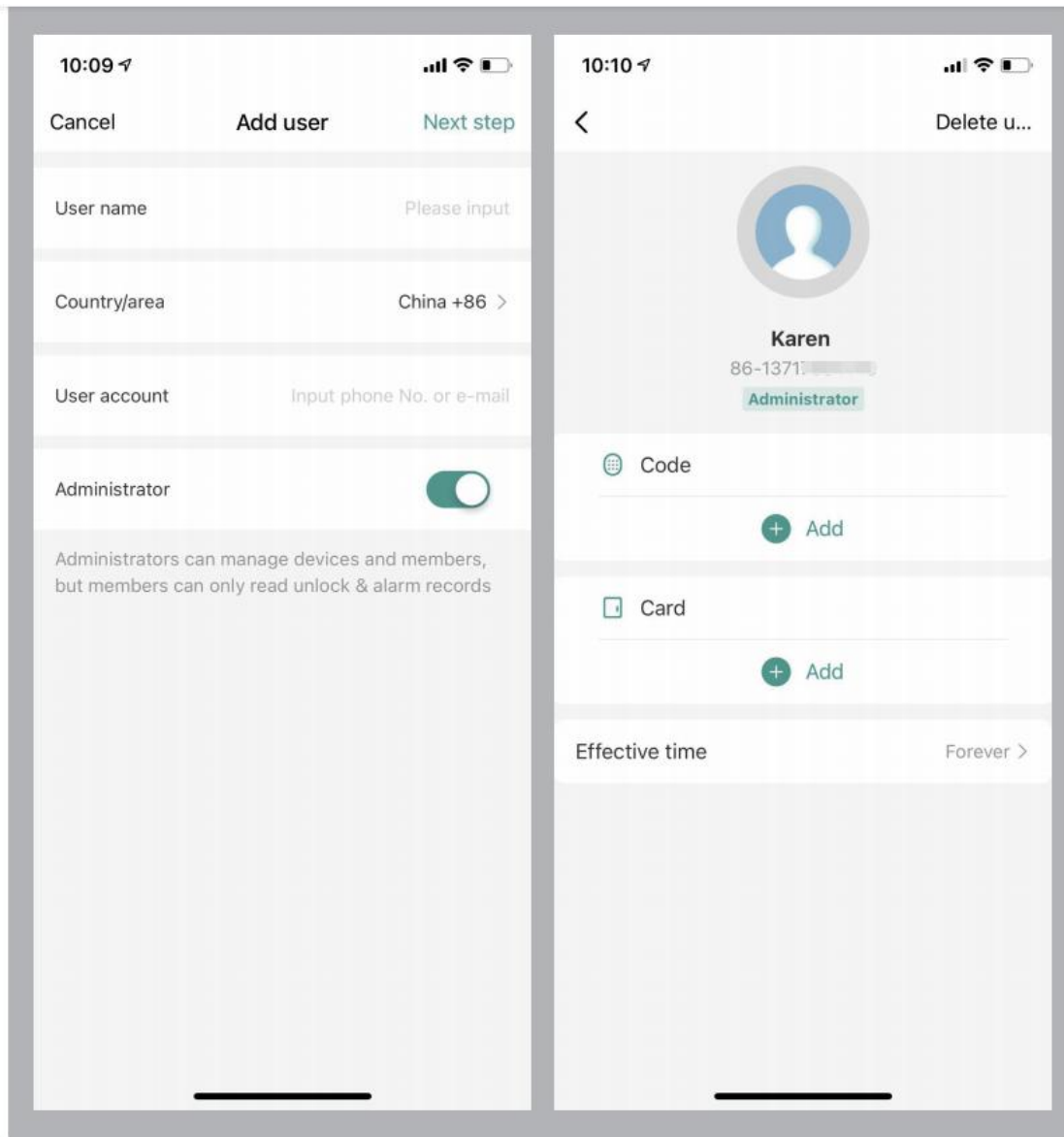

- 14 Add code user by clicking add temporary code cyclicity, and inputting six digits code or clicking randomly generated, then input code name.

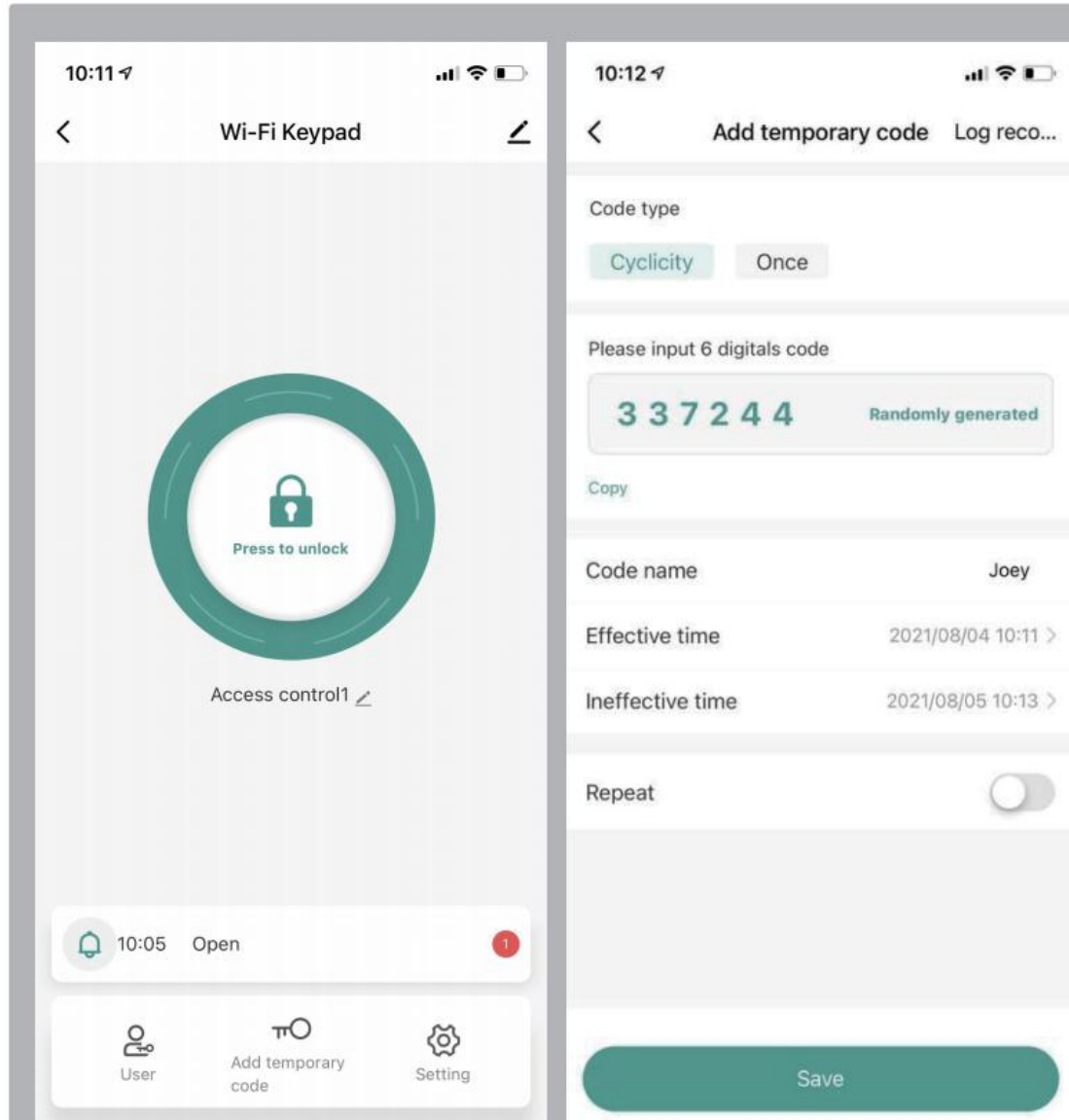

15 Set effective time and ineffective time, click “Save”.

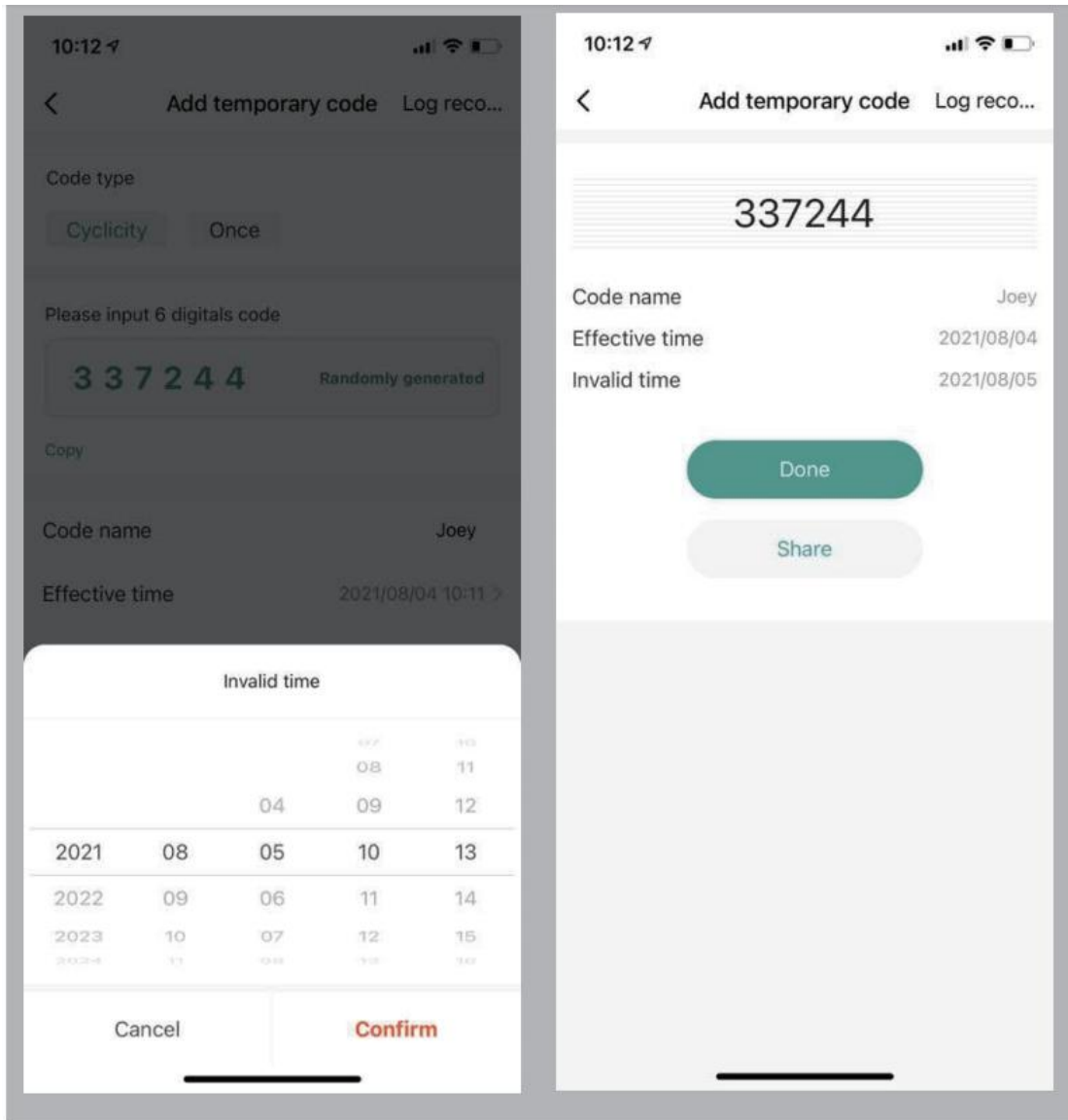

- 16** Add temporary code,click “Once”,input code name, click “Save offline code”, Done
Notice:The code valid time for 6 hours and only can be used once.

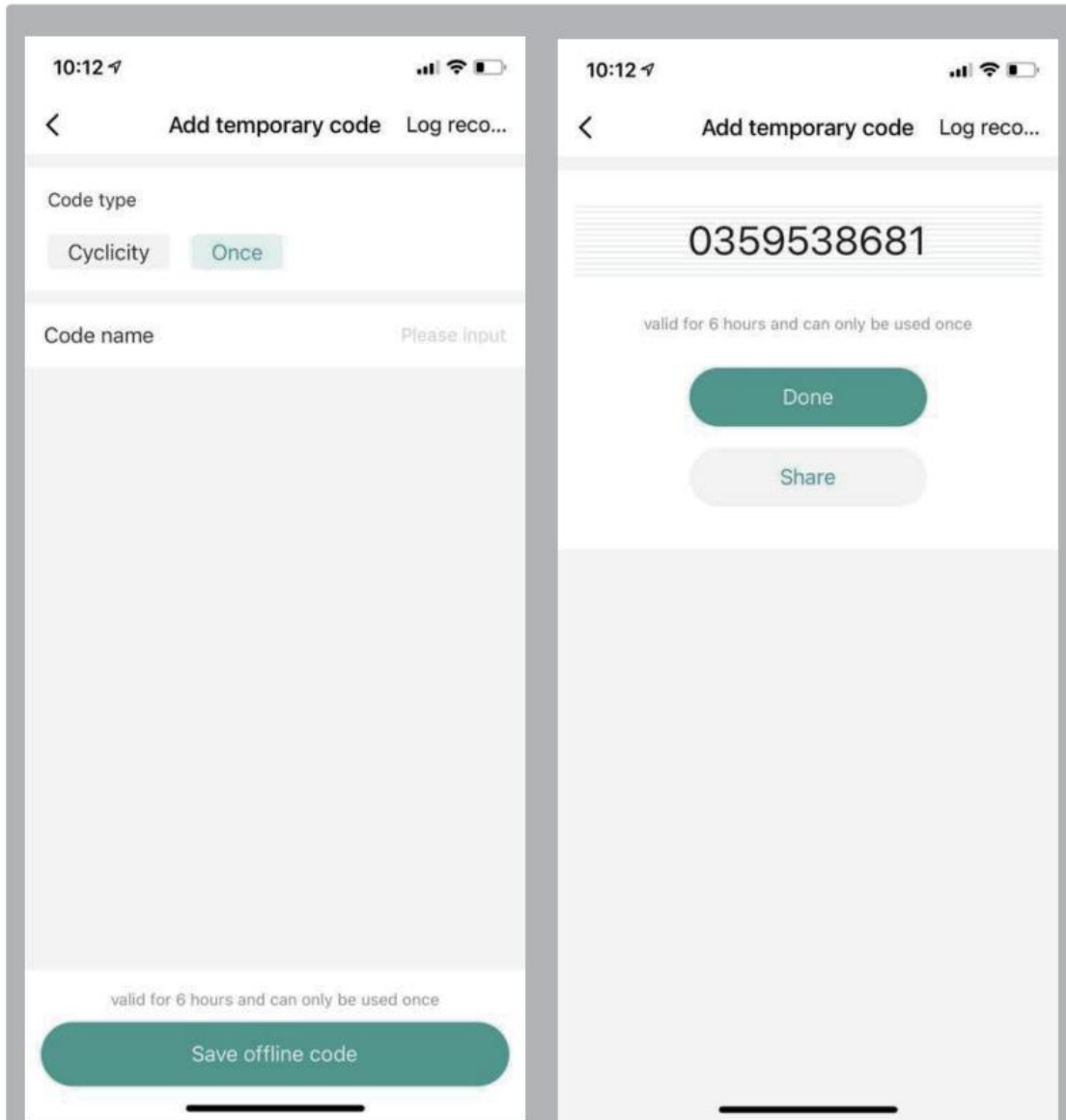

- 17** Door opening record check

10:13



Log

History

Alarms

Today

86-18566 [redacted] yoyo UnlockAccess control1

10:13

Unlock

10:05

86-15602 [redacted] UnlockAccess control1

10:04