

Multi function four axis DR-X5

Suitable for age 14+

An instruction manual

2.4GHz

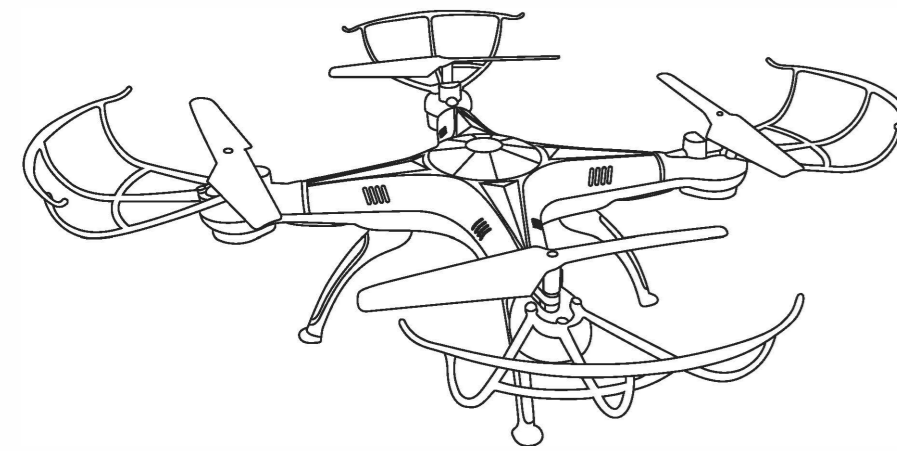

Main features

The use of a special plastic frame body, strong toughness, strong resistance to fall, the flight is more stable, suitable for indoor and outdoor flight. Built in six axis gyroscope stabilizer, can ensure the precise positioning of the air. Structure using modular design, installation is simple, easy maintenance. Detachable structure, functional change, can be rolled. The headless mode / return key.

1. Preface

- This product is not a toy. Possible damage to the use of the wrong.
- This flight model requires practice before you use it. Please use the product in accordance with the specification, do not disassemble this product. Otherwise, the manufacturer is not responsible for any damage.
- Thank you very much for choosing our remote control products. Please read the instruction carefully before you fly this product. Please provide a reference to the specification in the presence of failure. I hope you have a wonderful flight experience.

2. Safety instructions

Warning To fly in a safe area or away from others. Don't control aircraft in dense remote aircraft flying above the crowd, because of wrong operation or pilot radio interference in the process of operation, it is prone to accidents and malfunctions, easy to damage or harm people.

Prohibit Special indoor and outdoor flight, please stay away from obstacles

This product is suitable for indoor and outdoor flight (wind speed not more than 4 level), please select one, there are no obstacles, people and pets, passers-by places, for example, by the collision of landing entangled heat source, wire or electronic power supply will not cause fire, electric shock and loss of life and property.

Warning Please help with an experienced pilot

The product is mainly applied to 14 years of age or older, there is a certain degree of difficulty in the beginning of learning, it is recommended to please a pilot to guide the pilot.

Safety precautions:

- In order to ensure aviation radio (station) electromagnetic environment requirements; prohibit the use of all kinds of models for the remote control center and the radius of the 5000m area in the center to the airport runway. In the period of the relevant departments of the state to issue a radio control command, the regional area shall be stopped using the model remote control as required. Warm sunny days of flight, do not fly in the hot, cold, strong winds, heavy rain and other inclement weather conditions; selection of indoor or outdoor open areas, and keep a safe distance with people, pets, empty frame wire and other obstacles, confirmed that no other use the same frequency; cannot let the plane out of sight;
- After the aircraft is launched, please do not contact the high speed rotating part of the aircraft with the high speed rotating propeller to maintain a safe distance, so as to avoid the risk of injury. (including gears, rotors, etc.);
- After use and use of aircraft, the battery and motor will produce high temperature, do not touch, so as to avoid the risk of burns.
- Do not look directly at the light emitting diode light, so as not to affect the eyes.

3. Generally contain

3.7V lithium battery USB charging line Remote control Wind leaf x2 Bolt driver Instructions

4. Aircraft description

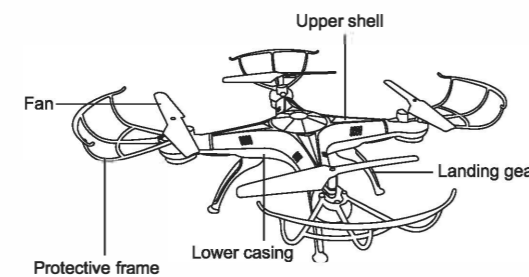

1

5. Remote control function description

Prohibit

Do not disassemble

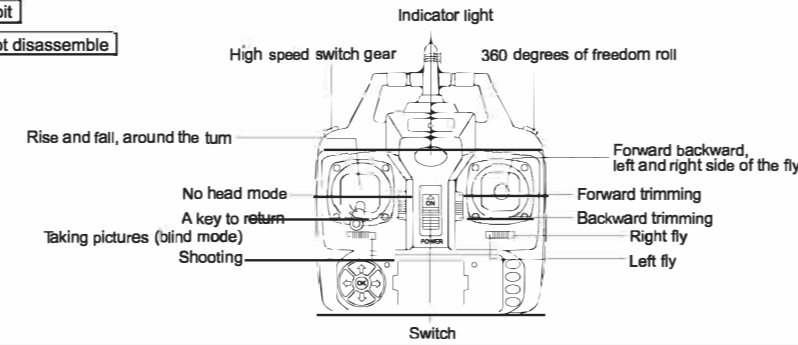

6. Remote control battery installation

Prohibit **Do not disassemble**

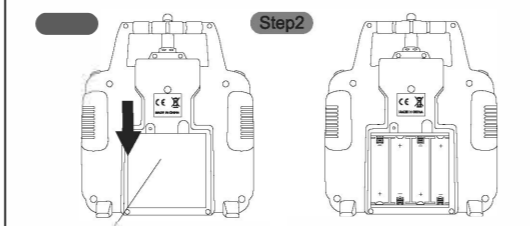

Battery safety instructions:
 -Different types of batteries or do not mix old and new batteries;
 -Non rechargeable battery can not be charged;
 -Can only use this product is equipped with a random charger for charging.
 -According to the positive and negative polarity of the battery, the power supply terminal shall not be short circuit.
 -Non rechargeable batteries can not be charged, rechargeable batteries can only be charged under adult supervision.
 -Do not recharge the rechargeable battery, charging people do not leave.
 -The exhausted battery should be taken out from the remote controller.
 -Please correct disposal of waste batteries according to the requirements of the environmental protection departments.
 -Do not put the battery into the fire, so as not to cause danger.

Lithium battery: lithium polymer battery with other battery is more dangerous, please be sure to read and follow the following note the use of the battery before use, the company will be responsible for the damage caused by any improper use. It is strictly prohibited to use the battery charger for charging, so as to avoid the risk of explosion and fire. No impact, dismantling, positive and negative electrode reverse, burning battery, to avoid the negative impact of metal items battery positive and negative electrode caused by short circuit. And please prevent sharp objects from piercing the battery to avoid the danger of battery fire. Please be careful when charging, make sure to charge in your line of sight. Children can contact and away from the place, in order to avoid danger. After the battery is used, if there is a fever, no charge. Otherwise, it will cause the expansion of the battery, deformation, explosion or even fire burning, endanger the safety of life and property. Waste battery, please in strict accordance with the use of national or regional waste clean-up act to recycle, so as not to pollute the environment.

7. Aircraft battery charging

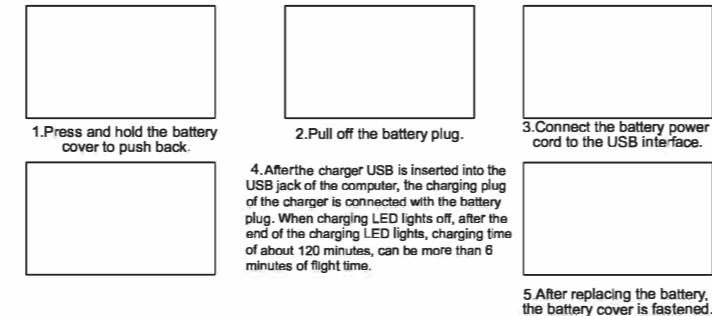

2

Aircraft charging time is about 120 minutes or so, can be more than 6 minutes of flight time.

Blade replacement

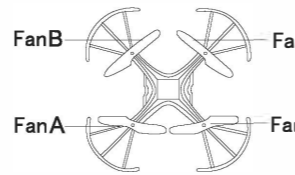

Important

- The wind blade to be replaced must correspond to the relative position of the body. Wind blade B to be installed in the B position, the wind blade A to be installed in the location of the A, such as the replacement of wind blade errors will not be able to control.
- When the flight leaves B clockwise rotation, the wind leaves A counterclockwise.

8. Ready to take off (as shown below)

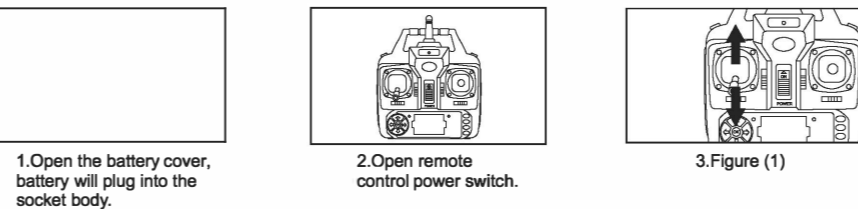

3. Open the plane and then open the switch, remote control switch, the light on the plane there will flash up and then push down the throttle control end, repeated two times to complete the frequency.

Warm reminder

- Before taking off, please be sure to put the aircraft on a horizontal plane to ensure a smooth flight after takeoff!
 - Flying in the room: please choose a spacious place with no obstacles, pets and people in the room.
 - Outdoor flight: please choose a warm, sunny and windy weather.
 - When the aircraft is not flying, the battery plug and the power plug of the machine body is disconnected, and the battery is prevented from damaging.
- Be careful: 1. Do not fly in extreme weather conditions, in the case of hot or cold weather, the flight will affect the flight effect or damage mode.
 2. Do not fly in the strong wind, the wind will cause the limit or will hinder your flight control. In the case of strong winds, flying, your aircraft will not be missing or to make it damaged.

9. Flight adjustment and setting

Practice flight simulation before you actually fly

- Please practice the following picture until you are familiar with the use of remote control.
- Aircraft in the open area, people stand in the back of the aircraft flight.
 - Operate the remote control lever one by one practice (each operation mode has 2 kinds of operation, as shown below), repeatedly control the operation of the left and right side of the fly, the throttle rise, fall, accurate forward, backward, left and right turn operation.
 - It is very important to simulate the flight exercise. Please repeat the exercise, until you are skilled, the fingers can control the.

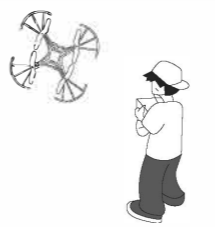

3

Aircraft function introduction

• Boot aircraft default is the low speed file

Pattern	Graphic	Pattern	Graphic
Flying side	Fly left, Fly right	Throttle	Rise, Decline
Forward and backward	Forward, Back off	Direction	Turn left, Turn right

- The headless mode: press the mode button head into the buzzer long ring head mode in endless mode, vehicle in the direction of the takeoff position, such as press the headless mode button, buzzer short a sound is closed without a head mode. No matter how far the aircraft flying, go to what direction, at this time pull forward, back / left / right side of the aircraft will fly back to the remote control. If the deviation (double rocker was toe calibration).
- A return: enter the headless mode, press the button to return, the aircraft will automatically start to take off to fly back to the position of. You can recognize the orientation of the vehicle, arbitrary flip right rocker, cancel to return.
- Throw flying action instructions: aircraft using six axis gyro, more fun. Throw the aircraft out or up at the same time push the accelerator push rod, the aircraft can be stationary in the air.
- 3D roll function: when the basic movements are very skilled when you can play some thrilling tumbling action, four-axis aircraft flew more than 3 meters height, press the remote control button on the upper right corner (roller button), remote Ming sound, the right lever forward / back / left / right to the highest point, the aircraft can achieve forward / back / left / right rolling function. Note: when the battery is full, the tumbling effect is the best.

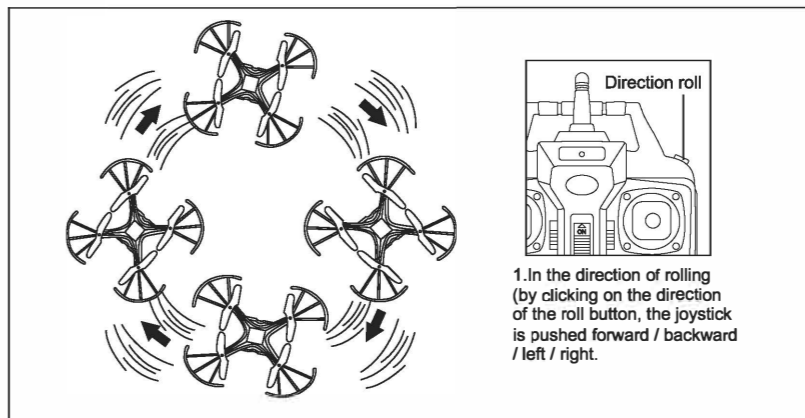
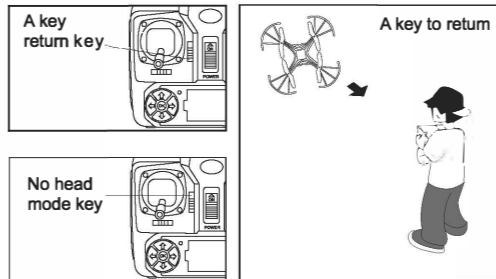

1. In the direction of rolling (by clicking on the direction of the roll button, the joystick is pushed forward / backward / left / right.

4

10. Automatic correction

The throttle around the steering lever and the left and right side flying joystick was toe as shown on the right. The aircraft indicator light is constantly flashing, and the calibration is done at this time.

Balance control in all directions

Slowly increase the throttle, lift off the ground, if the aircraft to fly in different directions. You can use the right joystick to control.

- left and right side of the aircraft to adjust the fine-tuning of the aircraft flying, the left and right side of the fly... When hovering over the aircraft to the right tilt, adjust the left fine tuning keys until smooth aircraft. When the aircraft hovering over the left tilt, adjust the right to fine tune the button until smooth aircraft.

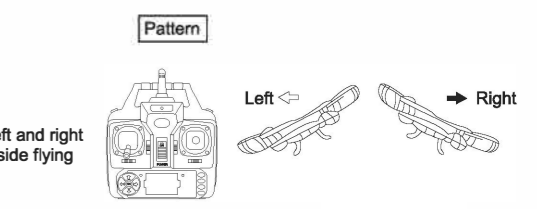

2. forward and backward adjustment to adjust the aircraft flying, forward, backward...

When the aircraft hovering forward tilt, can adjust the back button until the aircraft stable. When the aircraft hovering backward tilt, can adjust the forward fine tuning keys until smooth aircraft.

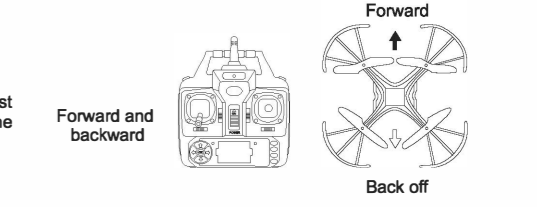

11. Trouble shooting

- Remote control and aircraft did not respond:
Solution: to ensure the success of the frequency.
- Gyroscope work is not normal:
Solution: 1) the battery voltage is too low
2) re - frequency
3) to ensure that the aircraft in the horizontal plane.
- Unable to roll:
Solution: 1) to detect the lithium battery is too low, need to charge.
- Aircraft fuselage shaking:
Solution: check whether the motor, casing, main body, and propeller are correctly positioned.
- Aircraft can not take off:
Solution: 1) check whether the installation of the wind blade is correct.
2) aircraft chassis is loose, hinder the rotation of the wind blade.
3) aircraft if there is electricity, low power, the aircraft inside and outside the lights flashing alternately.

Note: the flight must be far away from the crowd, highrise buildings, high voltage wires; while avoiding wind and rain, lightning and other severe weather flight. Aircraft is composed of a number of sophisticated electronic components and mechanical parts, so, must be to prevent the aircraft wet or water vapor into the body, so as to avoid mechanical and electronic components failure caused by accident.

5